

KLP LEVER HOIST PRODUCT # 110402,403,404,405,412,413,414

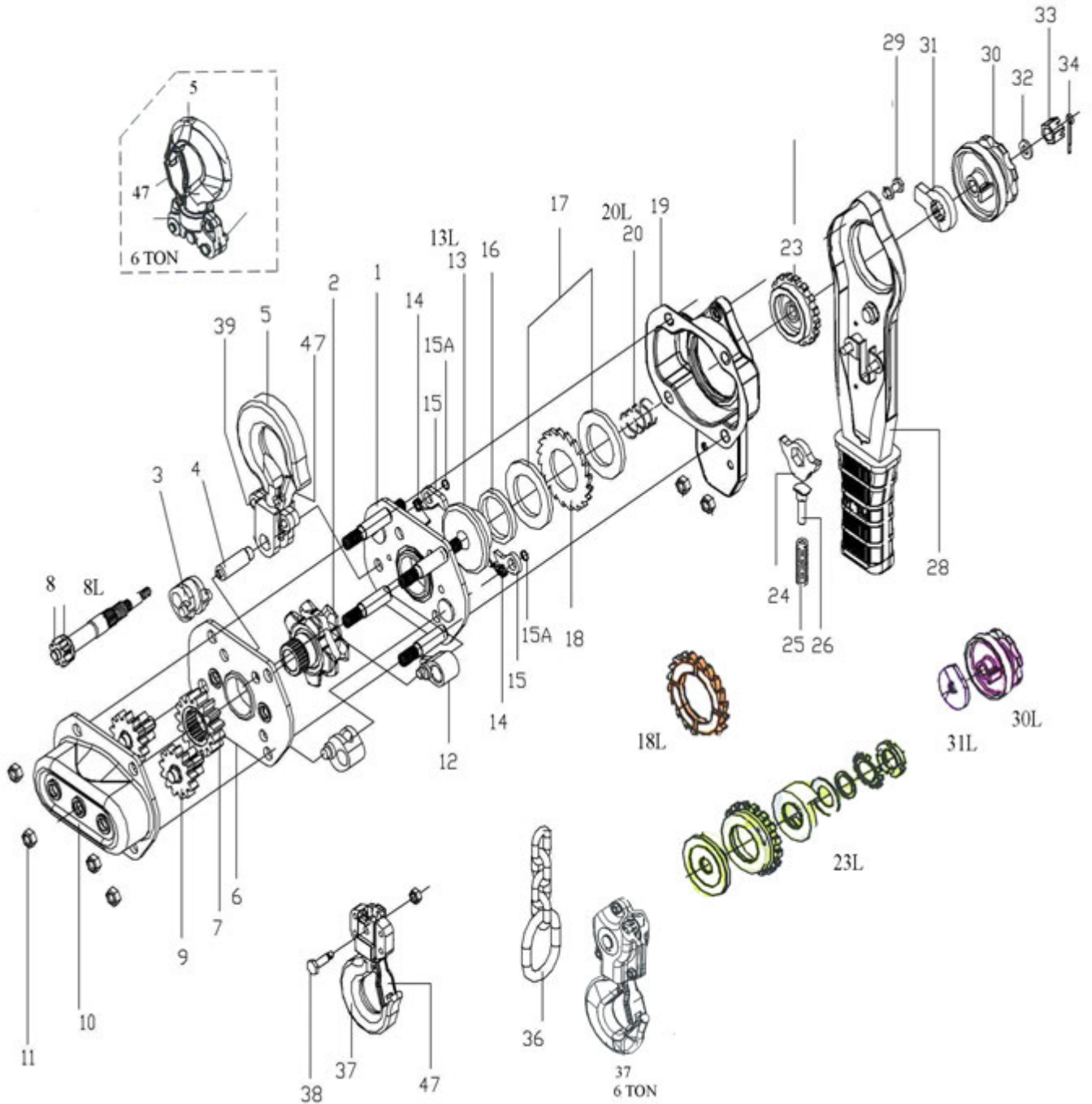

ITEMS WITH L AFTER REF # FOR OVERLOAD SYSTEM ONLY

KLP LEVER HOIST PRODUCT # 110402,403,404,405,412,413,414

| REF | PART NUMBER | PART NUMBER | PART NUMBER | PART NUMBER | PART NUMBER | DESCRIPTION | REQ |
|-----|---------------|----------------|----------------|---------------|---------------|--------------------------------|-----|
| 1 | PVI-KLP75-1 | PVI-KLP150-1 | PVI-KLP300-1 | PVI-KLP600-1 | PVI-KLP600-1 | LEFT SIDE PLATE ASSEMBLY | 1 |
| 2 | PVI-KLP75-2 | PVI-KLP150-2 | PVI-KLP300-2 | PVI-KLP600-2 | PVI-KLP600-2 | SPROCKET | 1 |
| 3 | PVI-KLP75-3 | PVI-KLP150-3 | PVI-KLP300-3 | PVI-KLP600-3 | PVI-KLP600-3 | CHAIN GUIDE | 2 |
| 5 | PVI-KLP75-5 | PVI-KLP150-5 | PVI-KLP300-5 | PVI-KLP600-5 | PVI-KLP600-5 | TOP HOOK ASSEMBLY, 4,5,47,48 | 1 |
| 6 | PVI-KLP75-6 | PVI-KLP150-6 | PVI-KLP300-6 | PVI-KLP600-6 | PVI-KLP600-6 | RIGHT SIDE PLATE ASSEMBLY | 1 |
| 7 | PVI-KLP75-7 | PVI-KLP150-7 | PVI-KLP300-7 | PVI-KLP600-7 | PVI-KLP600-7 | SPLINED GEAR | 1 |
| 8 | PVI-KLP75-8 | PVI-KLP150-8 | PVI-KLP300-8 | PVI-KLP600-8 | PVI-KLP600-8 | DRIVING PINION | 1 |
| 8L | PVI-KLP75-8L | PVI-KLP150-8L | PVI-KLP300-8L | | | DRIVING PINION OVERLOAD | 1 |
| 9 | PVI-KLP75-9 | PVI-KLP150-9 | PVI-KLP300-9 | PVI-KLP600-9 | PVI-KLP600-9 | PINION DISC GEAR SET | 1 |
| 10 | PVI-KLP75-10 | PVI-KLP150-10 | PVI-KLP300-10 | PVI-KLP600-10 | PVI-KLP600-10 | GEAR COVER ASSEMBLY | 1 |
| 11 | PVI-KLP75-11 | PVI-KLP150-11 | PVI-KLP300-11 | PVI-KLP600-11 | PVI-KLP600-11 | LOCKING NUT | 8 |
| 12 | PVI-KLP75-12 | PVI-KLP150-12 | PVI-KLP300-12 | PVI-KLP600-12 | PVI-KLP600-12 | CHAIN STRIPPER | 1 |
| 13 | PVI-KLP75-13 | PVI-KLP150-13 | PVI-KLP300-13 | PVI-KLP600-13 | PVI-KLP600-13 | BRAKE SEAT | 1 |
| 13L | PVI-KLP75-13L | PVI-KLP150-13L | PVI-KLP300-13L | | | BRAKE SEAT OVERLOAD | 1 |
| 14 | PVI-KLP75-14 | PVI-KLP150-14 | PVI-KLP300-14 | PVI-KLP600-14 | PVI-KLP600-14 | PAWL SPRING EACH | 2 |
| 15 | PVI-KLP75-15 | PVI-KLP150-15 | PVI-KLP300-15 | PVI-KLP600-15 | PVI-KLP600-15 | PAWL EACH | 2 |
| 16 | PVI-KLP75-16 | PVI-KLP150-16 | PVI-KLP300-16 | PVI-KLP600-16 | PVI-KLP600-16 | BUSHING | 1 |
| 17 | PVI-KLP75-17 | PVI-KLP150-17 | PVI-KLP300-17 | PVI-KLP600-17 | PVI-KLP600-17 | FRICITION DISC (1 SET = 2 PCS) | 1 |
| 18 | PVI-KLP75-18 | PVI-KLP150-18 | PVI-KLP300-18 | PVI-KLP600-18 | PVI-KLP600-18 | RATCHET DISC | 1 |
| 18L | PVI-KLP75-18L | PVI-KLP150-18L | PVI-KLP300-18L | | | FUSED BRAKE DISC | 1 |
| 20 | PVI-KLP75-20 | PVI-KLP150-20 | PVI-KLP300-20 | PVI-KLP600-20 | PVI-KLP600-20 | SPRING | 1 |
| 20L | PVI-KLP75-20L | PVI-KLP150-20L | PVI-KLP300-20L | | | SPRING OVERLOAD | 1 |
| 23 | PVI-KLP75-23 | PVI-KLP150-23 | PVI-KLP300-23 | PVI-KLP600-23 | PVI-KLP600-23 | CHANGE OVER GEAR | 1 |
| 19 | PVI-KLP75-19 | PVI-KLP150-19 | PVI-KLP300-19 | PVI-KLP600-19 | PVI-KLP600-19 | HANDLE COVER ASSEMBLY | 1 |
| 24 | PVI-KLP75-24 | PVI-KLP150-24 | PVI-KLP300-24 | PVI-KLP600-24 | PVI-KLP600-24 | CHANGE OVER PAWL ASS 25,26 | 1 |
| 27 | PVI-KLP75-27 | PVI-KLP150-27 | PVI-KLP300-27 | PVI-KLP600-27 | PVI-KLP600-27 | HANDLE SLEEVE | 1 |
| 28 | PVI-KLP75-28 | PVI-KLP150-28 | PVI-KLP300-28 | | | LEVER HANDLE ASSY | 1 |
| 30 | PVI-KLP75-30 | PVI-KLP150-30 | PVI-KLP300-30 | PVI-KLP600-30 | PVI-KLP600-30 | HAND WHEEL ASSY 31,32,33,34 | 1 |
| 30L | PVI-KLP75-30L | PVI-KLP150-30L | PVI-KLP300-30L | | | HAND WHEEL OVERLOAD | 1 |
| 31L | PVI-KLP75-31L | PVI-KLP150-31L | PVI-KLP300-31L | | | STOP KNOB | 1 |
| 36 | PVI-KLP75-36 | PVI-KLP150-36 | PVI-KLP300-36 | PVI-KLP600-36 | PVI-KLP600-36 | END CHAIN RING | 1 |
| 37 | PVI-KLP75-37 | PVI-KLP150-37 | PVI-KLP300-37 | PVI-KLP600-37 | PVI-KLP600-37 | BOTTOM HOOK ASSEMBLY | 1 |
| 47 | PVI-KLP75-47 | PVI-KLP150-47 | PVI-KLP300-47 | PVI-KLP600-47 | PVI-KLP600-47 | SAFETY LATCH KIT | 1 |