

MANUAL

#10 Series Cast Lever Chain Hoists - Super Heavy Duty

Prod. No. 110241, 110242, 110243, 110244

Mod. No. #10-2



 **WARNING**

1. **Read and understand the entire contents of this manual before attempting to use the puller.**
2. **This puller is designed and intended for use by properly trained and experienced personnel only. If you are not familiar with the proper and safe use of a puller, do not use until proper training and knowledge have been obtained.**
3. Do not use to lift people or loads over people.
4. Do not exceed the rated capacity of the puller.
5. Do not use a “cheater pipe” to extend the length of the puller handle.
6. Do not strike the handle with a hammer or any other object.
7. Do not use puller chain as a sling. This may cause damage to the chain.
8. Always inspect the puller for damage prior to use. If puller is damaged, do not use until it has been repaired or replaced.
9. Do not use more than one puller to lift or move a load. If this is unavoidable, each puller must have the same capacity as the load to be moved.
10. Never allow chain to “set” over sharp edges. All pulls or lifts must be made with straight chain that is free of obstacles.
11. If the puller lever is difficult to operate, then the load exceeds the capacity of the puller. Select a puller of larger capacity.
12. Do not use a puller if the chain is twisted, kinked or damaged.
13. Do not operate puller unless load is centered between top and bottom hooks.
14. Always take time to study the job to be performed and choose the safest method. Do not place yourself or other people in an unsafe position.
15. Leave all internal maintenance to a qualified JET service center.
16. Replace chain with factory replacement chain only. Do not use any other type of chain.
17. Never use the puller if either hook is stretched, deformed, or has a broken or missing safety latch. Always replace the safety latch and/or the hook before placing the puller back in service.
18. Understand and follow all procedures as set forth in American National Standards titled “Performance Standard for Manually Lever Operated Chain Hoists”. ANSI/ASME HST-3M. This standard is available through the American Society of Mechanical Engineers, 345 East 47th St., NY, NY 10017
19. Failure to comply with all of these warnings may cause serious injury and/or damage to property.

Specifications:

#10-2 Series Pullers

Product Number	110241
Model Number	#10-2
Body Type	Steel
Load Chain Diameter	5.6mm
Number of Falls	1
Rated Capacity	3/4 Ton
Distance Per Handle Pull	1-1/16"
Minimum Distance Between Hooks	12-3/8"
Standard Lift	5'
Pull to Lift Capacity	66 lbs (30 kg)
Lever Length	10-1/2"
Product Weight	17 lbs (7.7 kg)
Shipping Weight	23 lbs (10 kg)
Product Number	110242
Model Number	#10-2
Body Type	Steel
Load Chain Diameter	7.1mm
Number of Falls	1
Rated Capacity	1-1/2 Ton
Lift Per Full Turn of Lever	1-1/8"
Minimum Distance Between Hooks	14-15/16"
Standard Lift	5'
Pull to Lift Capacity	66 lbs (30 kg)
Lever Length	16-1/16"
Product Weight	27 lbs (13 kg)
Shipping Weight	28 lbs (13 kg)
Product Number	110243
Model Number	#10-2
Body Type	Steel
Load Chain Diameter	9.0mm
Number of Falls	1
Rated Capacity	3 Ton
Lift Per Full Turn of Lever	3/4"
Minimum Distance Between Hooks	18-7/8"
Standard Lift	5'
Pull to Lift Capacity	84 lbs (38 kg)
Lever Length	16-1/16"
Product Weight	41 lbs (19 kg)
Shipping Weight	44 lbs (20 kg)
Product Number	110244
Model Number	#10-2
Body Type	Steel
Load Chain Diameter	9.0mm
Number of Falls	2
Rated Capacity	6 Ton
Lift Per Full Turn of Lever	3/8"
Minimum Distance Between Hooks	23-7/8"
Standard Lift	5'
Pull to Lift Capacity	84 lbs (38 kg)
Lever Length	16-1/16"
Product Weight	73 lbs (34 kg)
Shipping Weight	75 lbs (33 kg)

Prior to Operation

1. With the lever in the up position, check for a clicking sound when the handle is rotated in a clockwise direction. Do not use if this sound is not present.
2. With the lever in the up position, check free play in handle rotation. Free play is measured by the distance the handle travels before resistance or gearing is felt. If free play has reached 3/4 of a turn, brake discs are worn and should be replaced by a JET authorized repair station.
3. If the puller has not been used for extended period of time, check for proper operation before putting into service. Apply a light coat of 30W oil to the chain.
4. The brake mechanism must be kept clean and free from dirt, water, and oil. Never allow oil to penetrate the braking mechanism. Always keep your puller clean and store in a clean, dry location.
5. It is not necessary to oil the chain. However, a periodic coating of 30W oil will cause easier operation and prolong the life of the chain.
6. Check the chain for damage and elongation. Use the chain gauge on the bottom end of the chain as a guide. If the chain links do not fit inside the chain gauge, as shown in Fig. 1, the chain must be replaced.

WARNING

The load chain supplied with your JET puller is designed, manufactured, and tested for proper fit and durability. Over a period of time, the chain may need to be replaced. For your own safety, use factory replacement chain only. Use of other than factory replacement chain may cause serious injury and/or damage to the puller.

7. The top and bottom hooks on your JET puller are designed to open and warn of an overload. It is important to check top and bottom hooks for proper opening. If the safety latch no longer contacts the hook opening, replace the hook. Another way to check the opening is by using the chain gauge. Position the gauge as in Fig. 2. If the gauge does not contact both sides of the

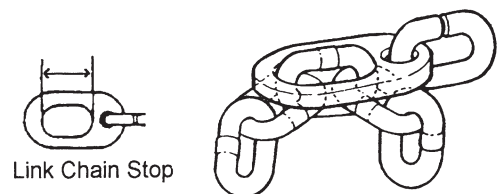

Fig. 1

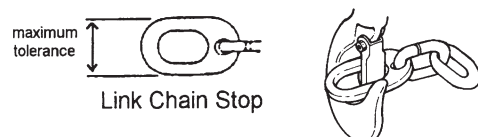

Fig. 2

Prior to Operation

hook, replace the hook. **Never side load top or bottom hook; this practice is dangerous and could lead to serious injury.**

8. If the vertical angle at the neck of the bottom or top hook reaches 10°, replace the hook. See Fig. 3.

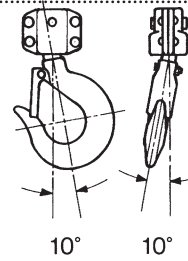

Fig. 3

Operation

1. Set the top hook securely.
2. Center load on bottom hook correctly. See Fig. 4. Incorrect loading is dangerous to the operator, the puller, and the load. Never load the hook in front of the safety latch (A, Fig. 5), load the hook tip (B, Fig. 5), load the hook off the centerline (C, Fig. 5), or load the hook sideways (D, Fig. 5).
3. Place direction lever on handle in the center neutral position (see Fig. 6) so that chain free-wheels. **Note:** Chain will only free wheel when there is no load. Take up slack by pulling on chain gauge end or by turning hand wheel.
4. Move direction lever to the up position. See Fig. 6. Pump handle up and down to raise or pull load. Do not overload the puller.
5. To release or lower load, turn direction lever on handle to the down position (see Fig. 6) and pump handle up and down.

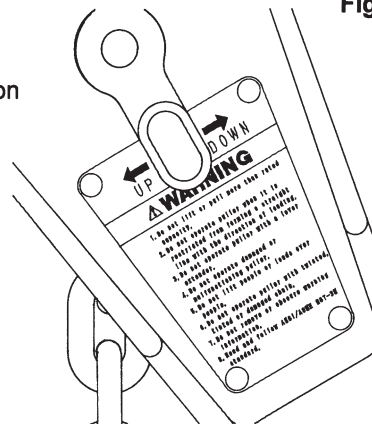
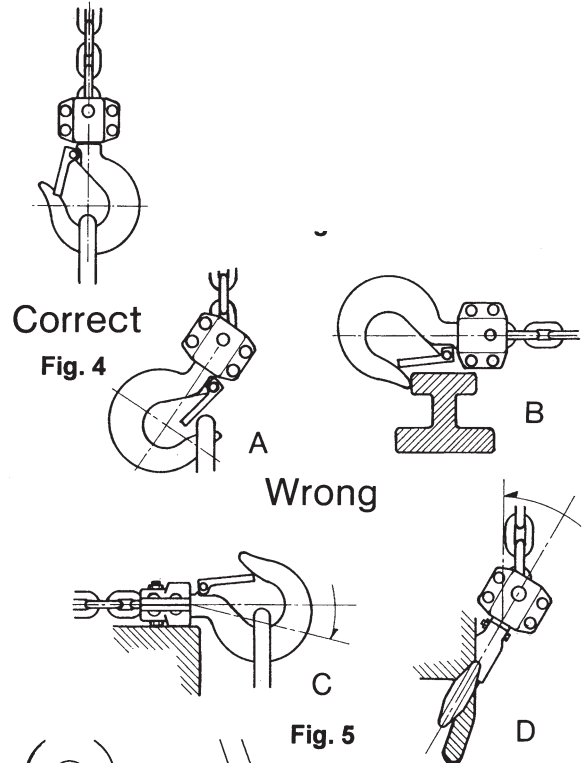

Fig. 6

Precautions

1. During pulling operations, the operator should stand near the side of the top hook on the opposite side of the lever. If the hand should slip off the lever, the lever will spring back away from the operator. See Fig. 7

Correct

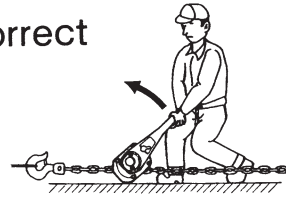
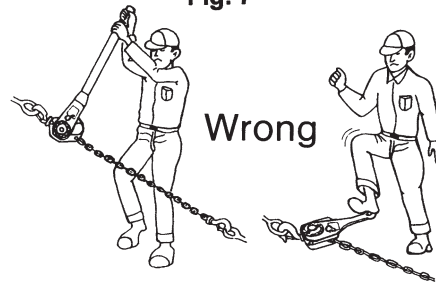

Fig. 7

2. During lifting operations, do not stand under the load.

3. Do not use an extension on the lever (A, Fig. 8). Do not use a foot to apply pressure to the lever (B, Fig. 8).



A

B

Fig. 8

4. Prevent the chain from dragging over sharp edges or corners. These will cause links to weaken, bend, or break. See Fig. 9.

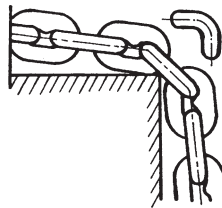

Fig. 9

5. When using a wire rope sling, the puller must be applied along a straight line parallel to the surface it is resting on. If it is necessary to bind around sharp edges or corners, the wire rope needs to be protected. See Fig. 10.

6. Pullers must not be used to secure load for transport. Use appropriate load binders or ratchet straps

7. When lifting loads, hook the load with slings. **Do not use the puller chain as a sling.** See Fig. 11.

8. Both ends of a sling or rope must be completely on the inside of the safety latch before pulling or lifting the load. Do not put one end on the inside of the latch and leave the other end on the hook end outside the latch.

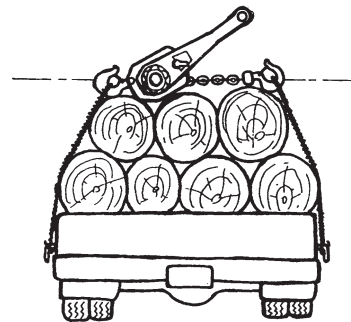
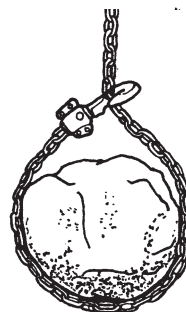

Fig. 10



Wrong



Correct

Fig. 11

**Parts List For The #10-2 Series 3/4 Ton Puller
Prod. No. 110241**

Please Order By Part Number Only

Index No.	Part No.	Description	Size	Qty.
1	JP75-1	Top Hook Assembly		1
5J	JP75-5J	Casing Assembly		1
8	JP75-8	Casing Assembly		1
11	JP75-11	Top Hook Pin		1
14	JP75-14	Split Pin	3x18	1
17	JP75-17	Load Sheave	5.6mm	1
20	JP75-20	Chain Guide	5.6mm	2
23	JP75-23	Stripper		1
26	JP75-26	Load Gear		1
29B	JPN75-29B	Washer	19.5x28x2	1
32B	JPN75-32B	Pinion		1
35B	JPN75-35B	Gear Assembly		2
39J	JP75-39J	Gear Cover		1
44B	JPN75-44B	Spring Washered Nut	M8	8
46	JP75-46	Disc Hub		1
48	JP75-48	Disc Brake	55x32x3.2	2
50	JP75-50	Ratchet Disc		1
52	JP75-52	Coil Spring		2
53	JP75-53	Brake Pawl		2
54	JP75-54	Snap Ring	10mm ID	3
55	JP75-55	Brake Cover Assembly		1
58J	JP75-58J	Handle Cover Assembly		1
60	JP75-60	Slide Ring		1
62B	JPN75-62B	Brake Hub		1
64B	JPN75-64B	Peeler		1
66	JP75-66	Coil Spring		1
67B	JPN75-67B	Ratchet		1
69	JP75-69	Snap Ring	25mm ID	1
70J	JP75-70J	Handle Assembly	268L	1
74	JP75-74	Plate Spring		1
75	JP75-75	Lever Pawl		1
77B	JPN75-77B	Hex Cap Bolt	M6x14	4
78	JP75-78	Stopper		1
79	JP75-79	Free Wheeling Spring		1
81B	JPN75-81B	Hand Wheel		1
82B	JPN75-82B	Hex Socket Cap Screw	M6x20	2
83	205610	Link Chain	5.6mm	1
86	JP75-86	Link Stop	5.6mm	1
89	JP75-89	Link Chain Stop		1
93B	JPN75-93B	Chain Stop Pin	6.9x30	1
97B	JPN75-97B	Grooved Nut	M6	1
102B	JPN75-102B	Bottom Hook Assembly		1
107J	JP75-107J	Name Plate (w/ two rivets)		1
114	JP75-114	Safety Latch Assembly		2

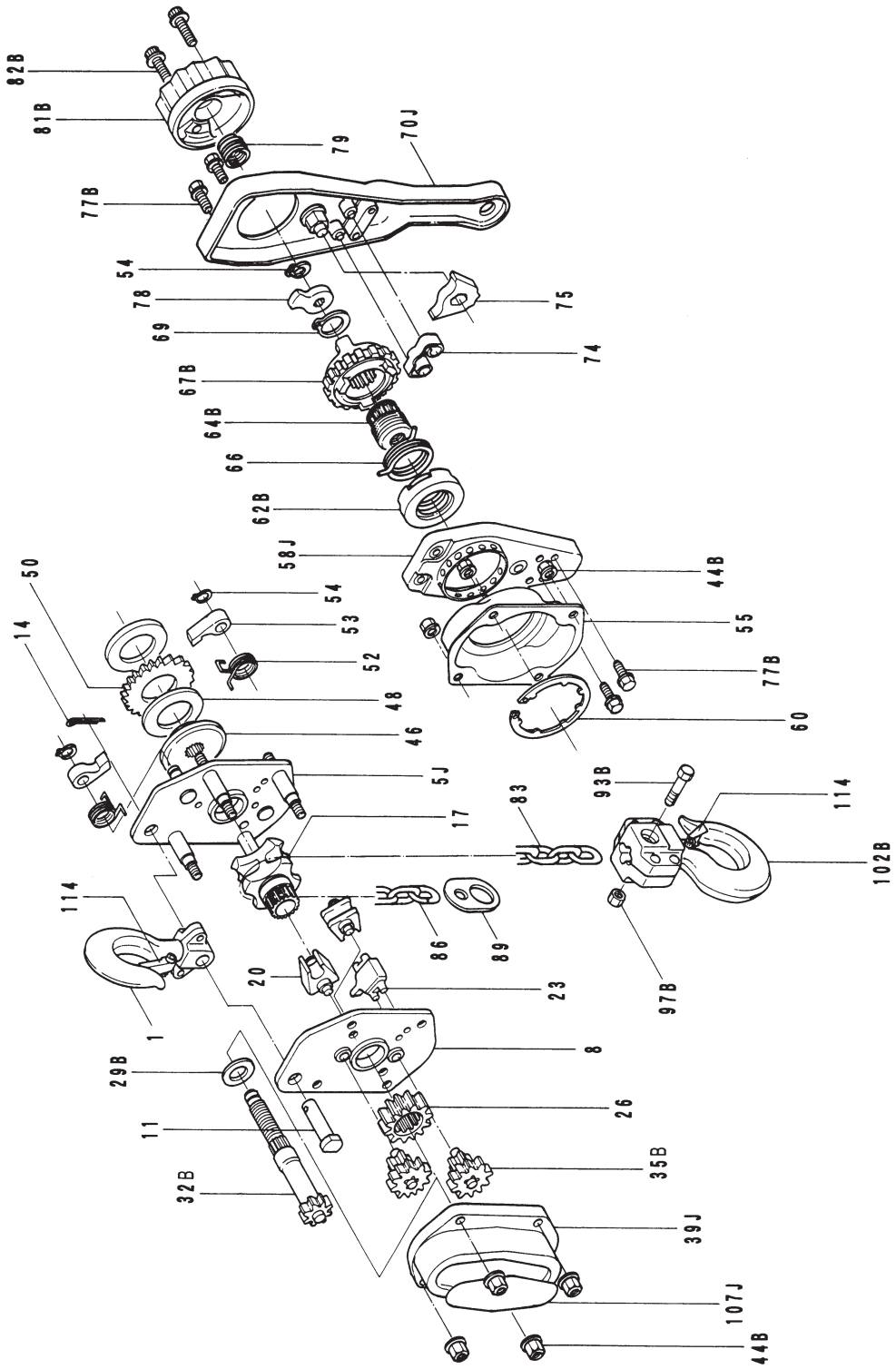

**Parts List For The #10-2 Series 1-1/2 Ton Puller
Prod. No. 110242**

Please Order By Part Number Only

Index No.	Part No.	Description	Size	Qty.
2	JP150-2	Top Hook Assembly		1
6J	JP150-6J	Casing Assembly		1
9B	JPN150-9B	Casing Assembly		1
12	JP150-12	Top Hook Pin		1
15	JP150-15	Split Pin	4x22	1
18	JP150-18	Load Sheave	7.1mm	1
21	JP150-21	Chain Guide	7.1mm	2
24	JP150-24	Stripper		1
27	JP150-27	Load Gear		1
30B	JPN150-30B	Washer	21.5x32x1.6	1
33B	JPN150-33B	Pinion		1
36B	JPN150-36B	Gear Assembly		1
38B	JPN150-38B	Gear Assembly		1
40BJ	JPN150-40BJ	Gear Cover		1
44B	JPN75-44B	Spring Washered Nut	M8	8
47	JP150-47	Disc Hub		1
49	JP150-49	Brake Disc	62x40x3.2	2
51	JP150-51	Ratchet Disc		1
52	JP75-52	Coil Spring		2
53	JP75-53	Brake Pawl		2
54	JP75-54	Snap Ring	10mm ID	3
56	JP150-56	Brake Cover Assembly		1
59J	JP150-59J	Handle Cover Assembly		1
61	JP150-61	Slide Ring		1
63B	JPN150-63B	Brake Hub		1
65B	JPN150-65B	Peeler		1
66	JP75-66	Coil Spring		1
68B	JPN150-68B	Ratchet		1
69	JP75-69	Snap Ring	25mm ID	1
71J	JP150-71J	Handle Assembly	408L	1
74	JP75-74	Plate Spring		1
75	JP75-75	Lever Pawl		1
77B	JPN75-77B	Hex Cap Bolt	M6x14	4
78	JP75-78	Stopper		1
80	JP150-80	Free Wheeling Spring	2.0	1
81B	JPN75-81B	Hand Wheel		1
82B	JPN75-82B	Hex Socket Cap Screw	M6x20	2
84	205611	Link Chain	7.1mm	1
87	JP150-87	Link Stop	7.1mm	1
90	JP150-90	Link Chain Stop		1
94B	JPN150-94B	Chain Stop Pin	8.7x39	1
97B	JPN75-97B	Grooved Nut	M6	1
103B	JPN150-103B	Bottom Hook Assembly		1
108J	JPN150-108J	Name Plate (w/ two rivets)		1
115	JP150-115	Safety Latch Assembly		2

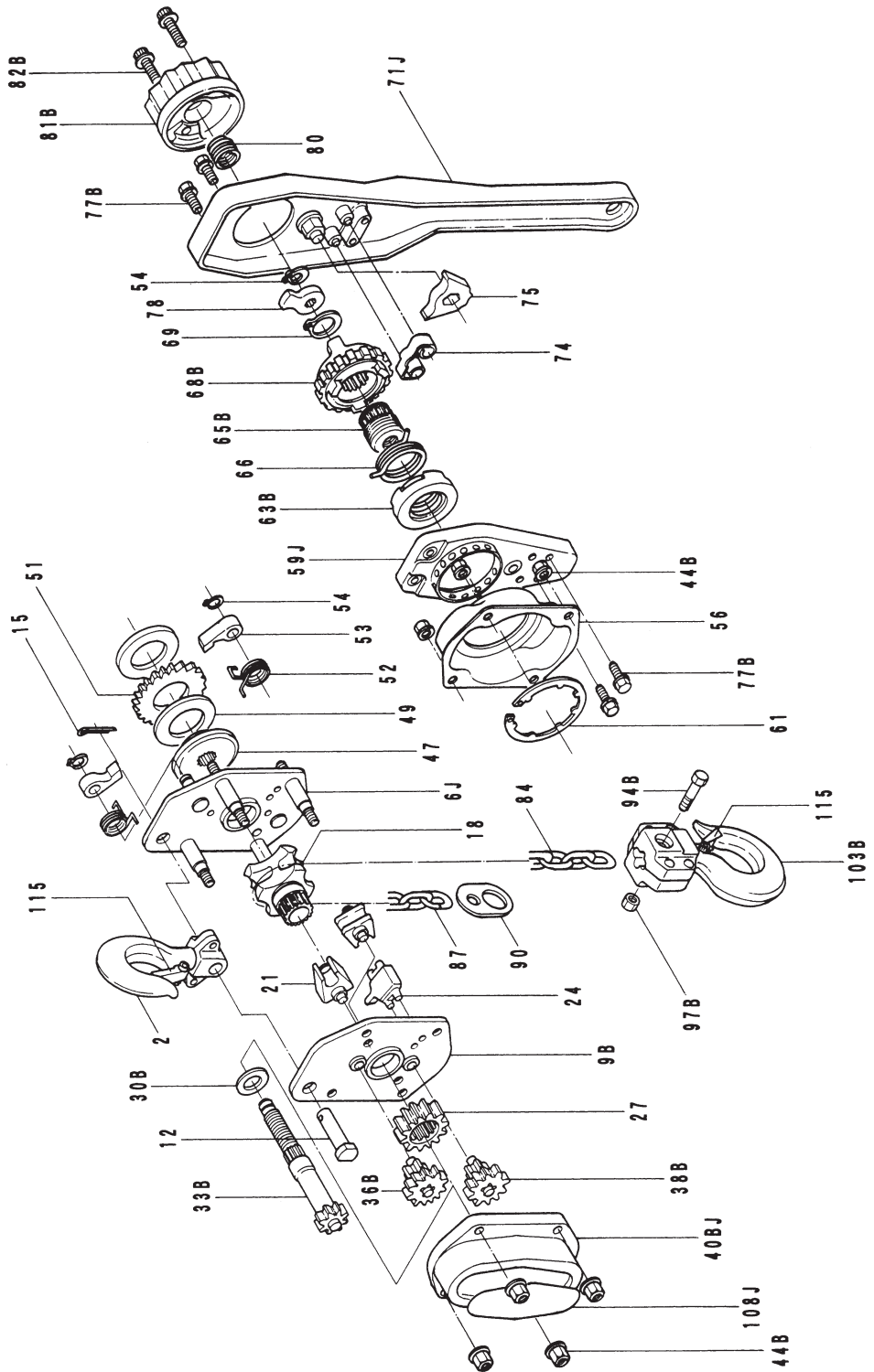

**Parts List For The #10-2 Series 3 Ton Puller
Prod. No. 110243**

Please Order By Part Number Only

Index No.	Part No.	Description	Size	Qty.
3	JP300-3	Top Hook Assembly		1
7JC	JP300-7JC	Casing Assembly		1
10BC	JPN300-10BC	Casing Assembly		1
13	JP300-13	Top Hook Pin		1
16	JP300-16	Split Pin	5x25	1
19C	JP300-19C	Load Sheave	9.0mm	1
22	JP300-22	Chain Guide	9.0mm	2
25	JP300-25	Stripper		1
28	JP300-28	Load Gear		1
31B	JPN300-31B	Washer	21.5x46x2	1
34B	JPN300-34B	Pinion		1
37B	JPN300-37B	Gear Assembly		2
41BJ	JPN300-41BJ	Gear Cover Assembly		1
45B	JPN300-45B	Spring Washered Nut	M10	8
47	JP150-47	Disc Hub		1
49	JP150-49	Brake Disk	62x40x3.2	2
51	JP150-51	Ratchet Disk		1
52	JP75-52	Coil Spring		2
53	JP75-53	Brake Pawl		2
54	JP75-54	Snap Ring	10mm ID	3
57	JP300-57	Brake Cover Assembly		1
59J	JP150-59J	Handle Cover Assembly		1
61	JP150-61	Slide Ring		1
63B	JPN150-63B	Brake Hub		1
65B	JPN150-65B	Peeler		1
66	JP75-66	Coil Spring		1
68B	JPN150-68B	Ratchet		1
69	JP75-69	Snap Ring	25mm ID	1
72J	JP300-72J	Handle Assembly	408L	1
74	JP75-74	Plate Spring		1
75	JP75-75	Lever Pawl		1
77B	JPN75-77B	Hex Cap Bolt	M6x14	4
78	JP75-78	Stopper		1
80	JP150-80	Free Wheeling Spring	2.0	1
81B	JPN75-81B	Hand Wheel		1
82B	JPN75-82B	Hex Socket Cap Screw	M6x20	2
85	205612	Link Chain	9.0mm	1
88	JP300-88	Link Stop	9.0mm	1
91	JP300-91	Link Chain Stop		1
95B	JPN300-95B	Chain Stop Pin	11.3x46.5	1
98B	JPN300-98B	Grooved Nut	M8	1
104B	JPN300-104B	Bottom Hook Assembly		1
109J	JP300-109J	Name Plate (w/ two rivets)		1
116	JP300-116	Safety Latch Assembly		2

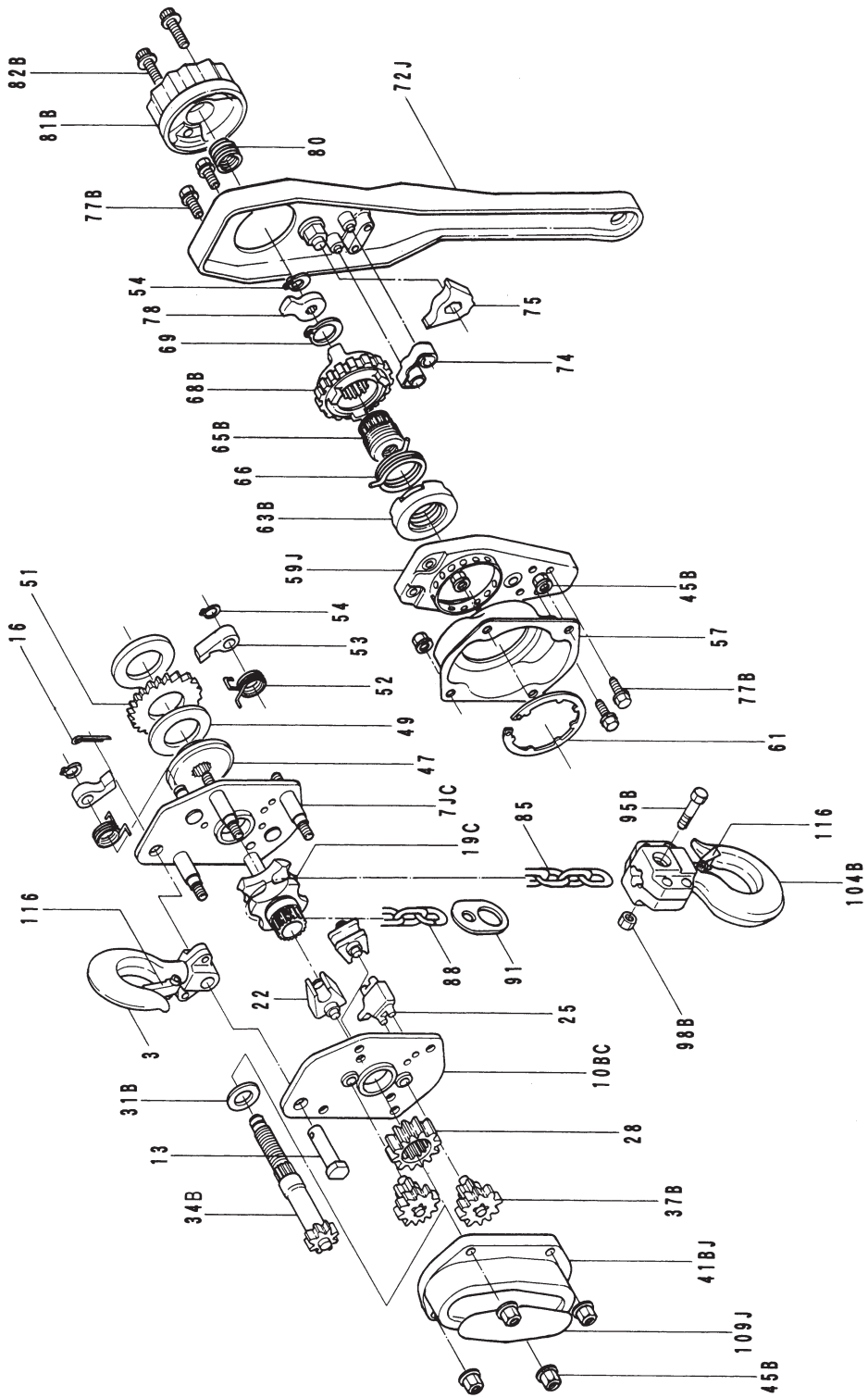

**Parts List For The #10-2 Series 6 Ton Puller
Prod. No. 110244**

Please Order By Part Number Only

Index No.	Part No.	Description	Size	Qty.
4	JP600-4	Top Hook Assembly		1
7JC	JP300-7JC	Casing Assembly		1
10BC	JPN300-10BC	Casing Assembly		1
13	JP300-13	Top Hook Pin		1
16	JP300-16	Split Pin	5x25	1
19C	JP300-19C	Load Sheave	9.0mm	1
22	JP300-22	Chain Guide	9.0mm	2
25	JP300-25	Stripper		1
28	JP300-28	Load Gear		1
31B	JPN300-31B	Washer	21.5x46x2	1
34B	JPN300-34B	Pinion		1
37B	JPN300-37B	Gear Assembly		2
41BJ	JPN300-41BJ	Gear Cover		1
45B	JPN300-45B	Spring Washered Nut	M10	8
47	JP300-47	Disc Hub		1
49	JP150-49	Brake Disk	62x40x3.2	2
51	JP150-51	Ratchet Disk		1
52	JP75-52	Coil Spring		2
53	JP75-53	Brake Pawl		2
54	JP75-54	Snap Ring	10mm ID	3
57	JP300-57	Brake Cover Assembly		1
59J	JP150-59J	Handle Cover Assembly		1
61	JP150-61	Slide Ring		1
63B	JPN150-63B	Brake Hub		1
65B	JPN150-65B	Peeler		1
66	JP75-66	Coil Spring		1
68B	JPN150-68B	Ratchet		1
69	JP75-69	Snap Ring	25mm ID	1
73J	JP600-73J	Handle Assembly	408L	1
74	JP75-74	Plate Spring		1
75	JP75-75	Lever Pawl		1
77B	JPN75-77B	Hex Cap Bolt	M6x14	4
78	JP75-78	Stopper		1
80	JP150-80	Free Wheeling Spring	2.0	1
81B	JPN75-81B	Hand Wheel		1
82B	JPN75-82B	Hex Socket Cap Screw	M6x20	2
85	205612	Link Chain	9.0mm	1
88	JP300-88	Link Stop	9.0mm	1
92	JP600-92	Link Chain Stop		1
96	JP600-96	Chain Stop Pin	11.3x51.5	1
101	JP600-101	Split Pin	3x18	1
105	JP600-105A	Bottom Hook Assembly		1
106	JP600-106	Bottom Sheave		1
110J	JP600-110J	Name Plate (w/ two rivets)		1
111P	JPN600-111P	Bottom Sheave Shaft		1

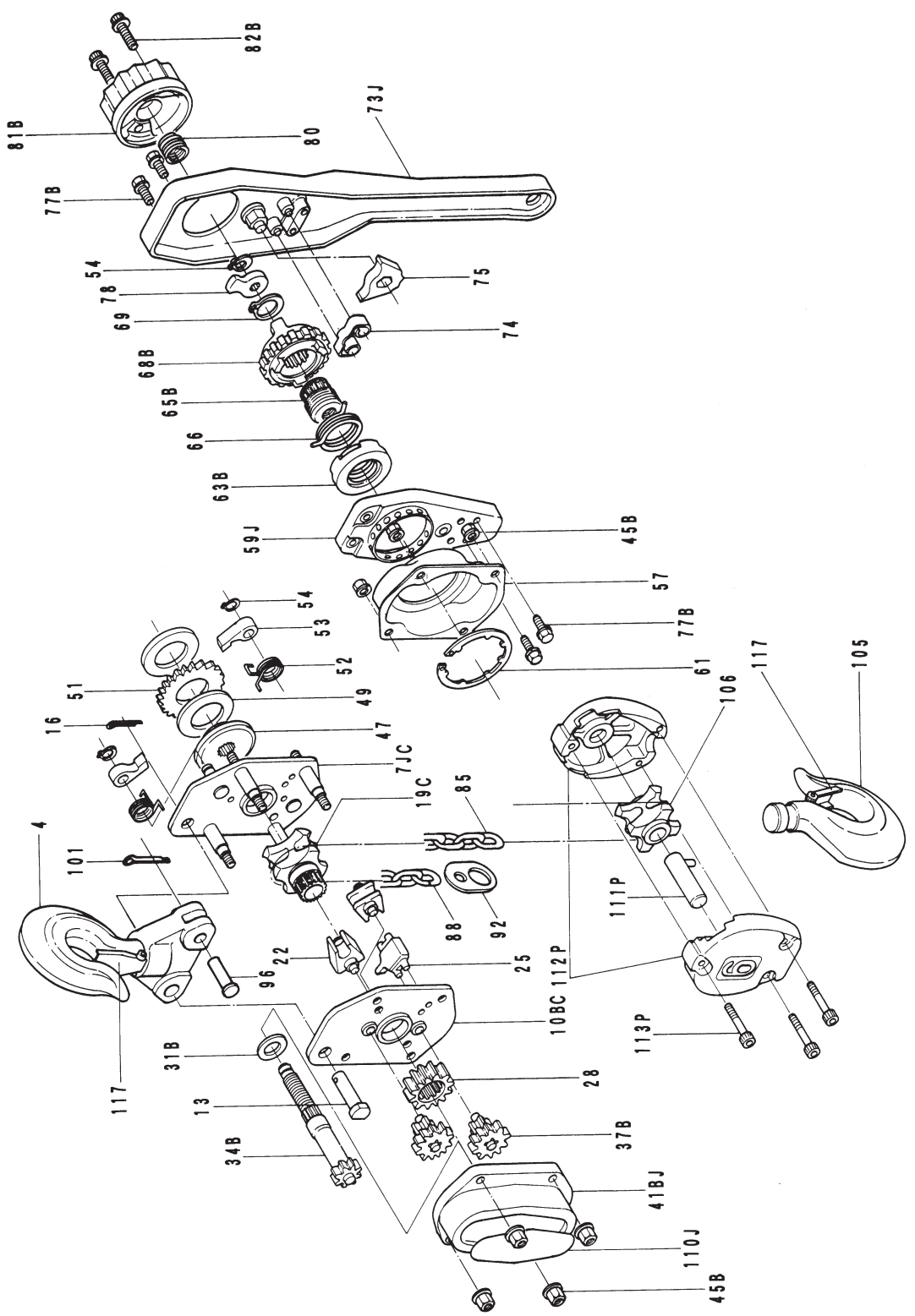

TEST CERTIFICATE

Type	
Serial No.	
Braking	
Working Load	
Inspected By	
Date	