

# Crosby® Forged Hooks



**SEE APPLICATION AND WARNING INFORMATION**

Para Español: [www.thecrosbygroup.com](http://www.thecrosbygroup.com)

On Pages 140-141

## S-3316



- Easily attaches to any chain and electric hoist with welded link load chain, roller chain or wire rope with suitable end fitting.
- Swivel jaw is forged.
- Suitable for infrequent, non-continuous rotation under load.
- Use in corrosive environment requires shank and nut inspection in accordance with ASME B30.10-1.10.4(b)(5)(c)2009.

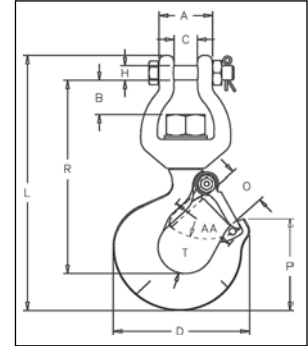

## S-3316 Replacement Hook

Working Load Limit (t)*	Frame Code	S-3316 Stock No	Weight Each (kg)	Dimensions (mm)										Replacement Latch Kit Stock No.
				A	B	C	D	H	L	O	P	R	T	
.45	F	1023029	.57	33.3	19.3	14.2	81.0	9.65	155	24.6	57.0	117	20.6	1096374
.91	H	1023047	1.18	39.6	25.4	17.5	104	11.2	195	28.4	72.0	148	30.2	1096468

\*Ultimate Load is 5 times the Working Load Limit.



## A-378



- Forged Alloy Steel - Quenched and Tempered.
- Deep straight throat permits efficient handling of flat plates or large cylindrical shapes.

## A-378 Sorting Hook

Working Load Limit at tip of Hook (t)*	Working Load Limit at bottom of Hook (t)*	A-378 Stock No	Style	Weight Each (kg)	Dimensions (mm)			
					I.D. of Eye	Overall Length	Opening at top of Hook	Radius at bottom of Hook
1.8	6.8	1028024	No Handle	2.91	35.0	246	71.4	15.9
1.8	6.8	1028033	With Handle	2.91	35.0	246	71.4	15.9

\*Ultimate Load is 4 times the Working Load Limit.

