

NIBCO® Press System® Large Diameter Fittings and Valves (2½", 3", 4") - Installation Instructions

For Types K, L and M Hard Copper Tubing in 2½", 3" and 4" Sizes

CAUTION

NIBCO 2½", 3" & 4" Press Fittings and Valves to be installed **ONLY** with:

- NIBCO PC-100 or PC-280 Pressing Tool
- NIBCO PC-5 Adapter Jaw
- NIBCO Pressing Chain - 2½" (PC-2), 3" (PC-3), 4" (PC-4)



1. Select clean, undamaged copper tube and cut square with a tube cutter to the desired length.

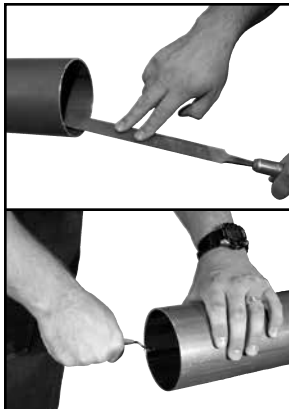

2. Deburr the tube inside diameter using a half-round file or deburring tool. Remove any copper shavings or filings.



3. Deburr the tube outside diameter using a half-round file to prevent damage to the EPDM seal. Clean the tube end of all contamination, oils, shavings and oxidation. A smooth transition chamfer is recommended to ease tube insertion past the seal.



4. Check the fitting to make sure that the seal is in place and is free of oil or grease. Only original NIBCO EPDM seals are to be used when making a press connection with NIBCO Press System fittings and valves. If it is necessary to lubricate the seals, use water only. **DO NOT** use any petroleum-based lubricants.



5. Mark the proper insertion depth on the tube with a permanent marker *prior* to insertion, based on insertion depth chart. Insert the tube into the fitting end using a twisting motion. Make sure that the tube is fully inserted. **If tube is not inserted to the proper depth, an inadequate seal may result.**

NIBCO® Press System® Insertion Depth Chart

Tube Size	2½"	3"	4"
Insertion Depth (min.)	1½"	1⅝"	2⅛"



6. Select the correct size pressing chain. Pull the pin on the chain which allows the segments to open. Position the chain on the raised bead and wrap the chain around the fitting with the "pipe side" designation facing the tube. When the chain is fully wrapped around the fitting, reinsert the pin to secure the chain on the assembled joint. Visually inspect the mark made in Step 5 to ensure the tube remained in position.



7. Release the pin (push and twist) on the jaw holder of the pressing tool, and install the adapter jaw on the tool. Return the pin to its original position, securing the jaw. The red sleeve on the tool must be in the back position to allow for crimping sizes 2½", 3" and 4". The red sleeve in the forward position allows for use with ½" - 2" standard pressing jaws.

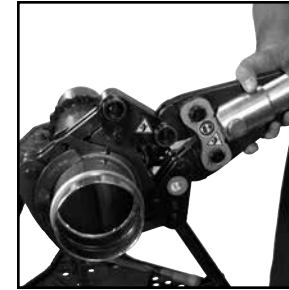

8. Squeeze adapter jaw arms to open the jaw. Rollers must be fully retracted to open the adapter jaw. Place the open adapter jaw into grooves in the pressing chain and let go of the jaw arms. Make sure the tube is inserted to the proper depth in the fitting (reference mark from #5). With the pressing tool perpendicular to the tube, begin the pressing cycle by pulling the trigger of the tool.

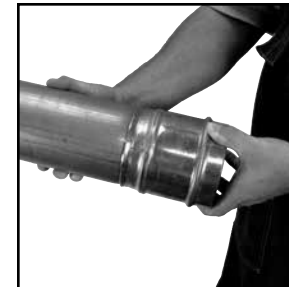

9. Keep the trigger engaged until the rollers fully retract and the cycle is complete. Then remove the pressing tool and adapter jaw from the pressing chain. Remove the pressing chain from the fitting.
10. Final crimp should appear pressed uniformly around the fitting.

▲ WARNING

Read press tool operator's manual and fitting manufacturer's installation instructions before using. Failure to follow all instructions may result in extensive property damage and/or serious personal injury. Call the NIBCO Technical Service Department at 1.888.446.4226 if you have any questions or need assistance.

▲ ADVERTENCIA

Antes de usar, lea el Manual del Operario de esta herramienta de presión y las instrucciones de instalación del acoplamiento (fitting) proporcionadas por su fabricante. Pueden ocurrir daños materiales de gran envergadura y lesiones corporales de gravedad si no se respetan todas las instrucciones. Si tiene alguna pregunta o necesita ayuda, llame al Departamento de Servicio Técnico de NIBCO al 1.888.446.4226.

▲ MISE EN GARDE !

Familiarisez-vous avec le mode d'emploi de la presse et les instructions du fabricant des raccords avant d'utiliser l'appareil. Le non-respect de leurs consignes risquerait d'augmenter les risques de dégâts matériels importants et/ou de graves blessures corporelles. Veuillez adresser toutes questions éventuelles ou demande d'aide au service technique de NIBCO en composant le 1.888.446.4226.