

MBK-6 DrainKat™ Instructions

The MBK-6 DrainKat™ condensate drain line cleaning kit uses a dry nitrogen or CO₂ charge to clear drain line clogs. The Drain Kat also uses the included blow gun in conjunction with the QN-S3 to clean off dirt and debris from HVAC coils.



CO₂ and Nitrogen Filling

CARBON DIOXIDE (CO₂) FILLING:

1. Disconnect hose and unscrew regulator from the DrainKat.
2. Turn over and vent off any remaining contents from the DrainKat. This can be an effective way to pre-chill the cylinder – see warning below.
3. Weigh the small cylinder, and record the tare weight.

OPERATOR'S TIP: Slightly open the valve of the parent cylinder at this point to vent off any vaporized CO₂ in the dip tube. Within 5 seconds a white snow like discharge indicates liquid CO₂ is available to be transfilled. Vapor type cylinders will have to be inverted to extract liquid. (See illustration #2.)

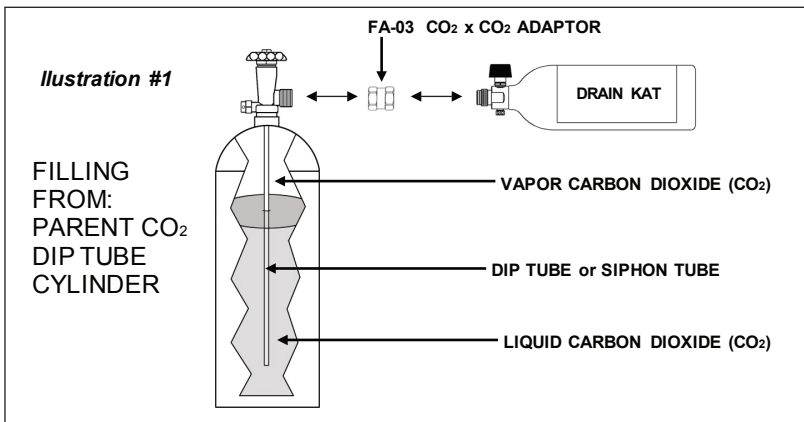

4. Connect the DrainKat to the parent cylinder using the FA-03 adaptor. (See illustrations #1 & 2)

WARNING: *Colder cylinders accept more CO₂ while filling. Cylinders that are cold or that have been pre-chilled before being filled must be weighed to confirm they are not overfilled.*

5. With cylinders hand tightened together, open the DrainKat, then slowly open the parent cylinder allowing pressure to equalize.
6. When flow stops, close both cylinder valves, and disconnect the cylinders by unscrewing the adaptor.
7. There will be a slight release of gas between the two cylinders upon disconnecting.
8. Re-weigh the DrainKat, and subtract the tare weight. This is the contents weight.
9. Check the contents against the rated capacity of the Drain Kat usually stamped into the neck of the cylinder. If the cylinder is overfilled, release the excess contents immediately.

WARNING: *OVERFILLED CYLINDERS ARE DANGEROUS! Always check contents weight on an accurate scale.*

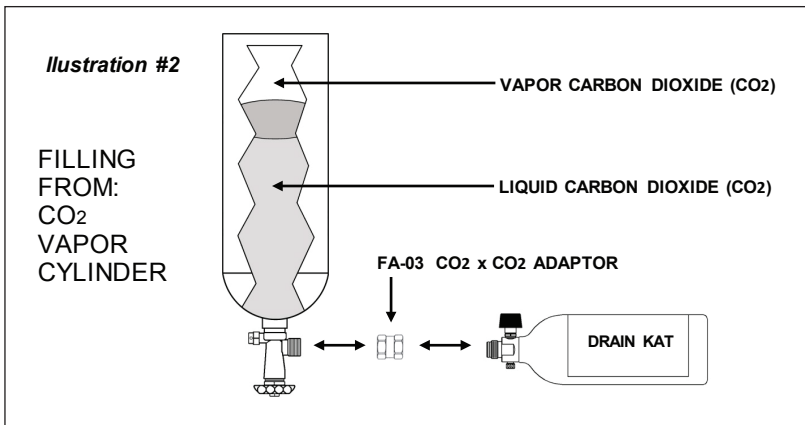

NITROGEN FILLING:

1. Disconnect hose and unscrew regulator from the DrainKat.
2. Connect FA-03 and FA-01 adaptors onto the DrainKat cylinder valve. (See illustration #3)
3. Connect the DrainKat onto the larger nitrogen cylinder (mother cylinder).
4. Open the DrainKat, then slowly open the parent cylinder allowing pressure to equalize.
5. Completely close both cylinder valves, and disconnect the cylinders by unscrewing the adaptors.
6. There will be a slight release of gas between the two cylinders upon disconnecting.
7. Check for continuous leaks.

CAUTION: *This equalizing transfill does not overfill the DrainKat when using a standard 2015 psi 40 Cu.Ft. or 80 Cu.Ft. parent cylinder. Larger capacity or higher pressure parent cylinders require the use of a system to prevent pressures over 1800 psi from entering the DrainKat.*

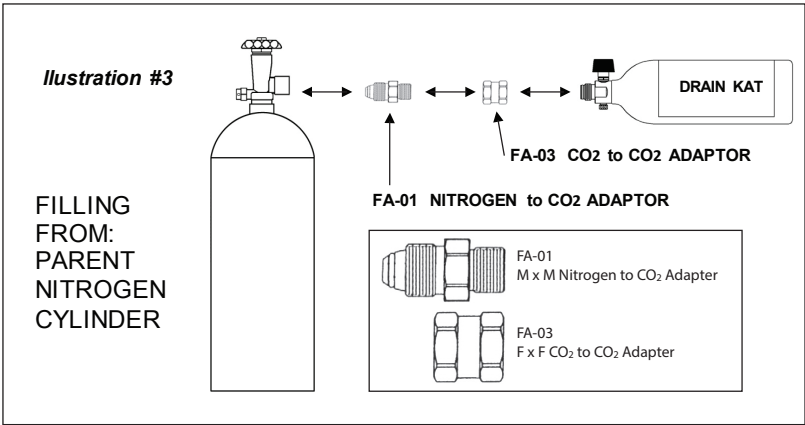

Warnings

- This product contains chemicals, including lead, or otherwise known to the State of California to cause cancer, birth defects, and other reproductive harm. Wash hands after handling (California Health & Safety Code § 25249.5 et seq.)
- Caution: cylinders are highly pressurized. Always handle with care. Never allow cylinders to be dropped, knocked over or subjected to excessive heat.
- Never stand in front of or behind a regulator or tank when opening the cylinder valve. Always stand so that the cylinder is between you and the regulator.
- Do not use the regulator if there are any damaged parts on the regulator, cylinder, or valve.
- Regulator outlet pressure must not be greater than 400 psi when using the blow gun. This is the maximum pressure rating for the blow gun. Regulator outlet pressure must not exceed 30 psi when using the QN-S3 tip.

Included Accessories



QN-S3

This accessory is used to remove compressed dirt and debris from a coil. To use this accessory, connect the QN-S3 to the tip of the blow gun. Do not exceed 30psi. CO₂ or Nitrogen can be used.

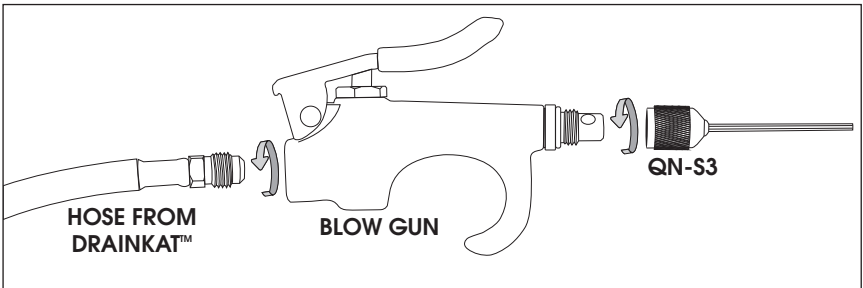

Included Accessories (cont.)



CW-15

This small section of red hose (whip hose) connects to the tip of the blow gun and then to the DF-75 DrainDawg.



DF-75 DrainDawg

This item can be used to clear clogs in drain pipes. In order to use this accessory, the included CW-15 short red hose must be connected to the blow gun of the DrainKat. To connect the CW-15 hose, rotate the stationary end of the CW-15 hose around the blow gun tip then connect the rotatable end of the red hose to the DF-75 DrainDawg. Do not exceed 140psi with the DF-75. The DF-75 is only to be used with 3/4"-1" diameter pipe.

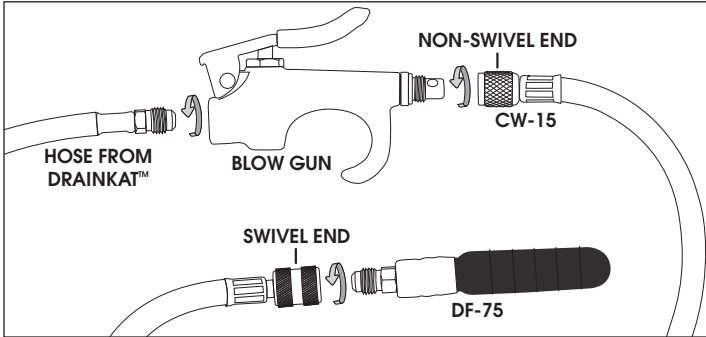

When using the DrainDawg accessory to clear a drain line, be sure to insert the DrainDawg fully into the pipe.

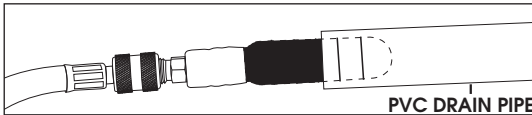
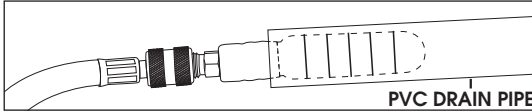

CB-03

The CB-03 can be used with other pipe sizes that may not work with the DF-75 DrainDawg. To use this accessory, connect the CB-03 to the tip of the blow gun. Do not exceed 100psi. CO₂ or Nitrogen can be used.

